

Operation Manual

English



MIX 4 MS

Order No.: 30404

Includes

Quick start
Operation Manual
Technical Documentation
Specifications

Thank you for your confidence shown in us!

Congratulations to the purchase of your new product.

For any enquiries, questions or suggestions please do not hesitate to contact us at info@2mag.de.

2mag

Main competence of **2mag** is based upon mixing, tempering and measuring/controlling. In these fields we are offering support with our products to the modern laboratory within the standardized daily business as well as for the implementation of highly complex processes in the state-of-the-art research. Due to the fact that **2mag** is developing according to customer's needs, is manufacturing self-contained and under permanent quality control and is also selling on-site together with competent contact persons, we can guaranty our customer an outstanding quality and product performance.

Contents

A Quick start	3
1. Overview of your product	3
2. Application fields	4
2.1 Operator	4
2.2 Basic functions	4
2.3 Product combinations	4
2.4 Application not for the intended use	4
2.5 Combinations of vessels	5
2.6 Stirring bars	6
2.6.1 ASTEROID Stirring Bars	6
2.7 Tips and hints to the topic stirring	7
3. Installation	8
3.1 Safety advice	8
3.2 Installation, connection to the magnetic stirrer	9
4. Operation of the magnetic stirrer MIX 4 MS	10
4.1 Description operating elements	10
4.2 Stirring operation and stirrer control	11
4.3 Warning notices:	13
B Maintenance, Cleaning and Care	14
C Service case and customer service	15
D Errors	16
E Technical details	17

A Quick start

1. Overview of your product

Magnetic stirrer MIX 4 MS



Image 2: 4-position magnetic stirrer MIX 4 MS (without power supply unit 100-240 volts)

Your product contains at despatch:

- A modern inductive magnetic stirring system (**MIX 4 MS**) consisting of a stainless steel stirring plate with 4 stirring points.
- An external power supply unit (100-240V / 48 V) with fixed cable for connecting the magnetic stirrer and pluggable power cable (country-specific).

2. Application fields

2.1 Operator

The 100% maintenance- and wear-free magnetic stirrers

MIX 4 MS

are used in the fields of chemistry, medicine, pharmacy, microbiology and biotechnology.

The operators are generally working in research and development, production and quality assurance.

2.2 Basic functions

Basic function is stirring of liquids in suitable and chemically resistible vessels.

The stirrer housing is hermetically closed and therefore easy to clean under running water.

Please ensure BEFORE you connect the power supply unit again that the socket is 100% dried!

The maximum ambient temperature is +50°C in air.

2.3 Product combinations

In addition to the use at the conventional laboratory desk our products have also been tested for the application in

- Laminar flow devices
- Safety cabinets
- Safety cabins

2.4 Application not for the intended use

The magnetic stirrers **MIX 4 MS** are **explicitly not intended** for the application:



- Stirring and warming of flammable liquids
- Warming of pressure-tight closed and NOT pressure-resistant vessels or glasses (e.g. Erlenmeyer flasks, lab flasks)
- At general atmosphere or danger of explosion
- Using immersed in water or oil baths
- Using in incubators (lost heat of the stirrer)

The **2mag** is offering special products for the just mentioned application combinations. More information for this can be found at

<http://www.2mag.de> or at info@2mag.de

2.5 Combinations of vessels

Please use round, chemical resistant and where required heat-resistant vessels made of glass or non-magnetic metal. You can use vessels up to the maximum size stated in the spreadsheet 1.

The vessels should have a thin, even wall thickness. Flat glass bottoms (without any curve to the inside) and smooth surfaces will improve the operating characteristic of the magnetic stirring bar. Uneven surfaces would reduce the stirring power and would cause reaming up of the stirring bar's gliding surface.

In case you intend to stir large amount of liquids, please chose such stirring flasks that have a comparatively small diameter and thin bottom. The magnetic stirring bar can then be centred better.

Magnetic Stirrer	Stirring vessels	Nominal content	Max. amount
MIX 4 MS	Erlenmeyer flasks und lab flasks	25 ml	4
		50/100 ml	4
		250/500 ml	4
		1000 ml	4
		2000 ml	4
		3000 ml	2
	beaker glass(high design)	25 ml	4
		50 ml	4
		100/250 ml	4
		600/1000 ml	4
		3000 ml	4
		3000 ml	2

Spreadsheet 1: Combination examples for vessels



Please always place the flasks in the magnetic centre of the magnetic stirrer. This will ensure the optimum stirring effect!



Do never use any pressure-tight closed flasks.

RISK OF BURSTING!



**Do only use temperature-resistant vessels.
Be careful with plastic flasks!**

2.6 Stirring bars

In general, all stirring bars matching the length and diameter can be used. But we recommend using the commercial stirring bars with Samarium Cobalt magnetic core (SmCo). By using this highly energetic magnetic material the maximum stirring power of the magnetic stirrer can be achieved, especially when mixing viscose media.

2.6.1 ASTEROID Stirring Bars

We recommend using 2mag –ASTEROID stirring bars to increase the stirring performance at enhanced requirements.

ASTEROID stirring bars a newly developed, high-effective and ideal for:

- large mixing volumes
- viscous media
- stirring over wide distances
- at disadvantageous vessel bottoms.

2mag ASTEROID stirring bars transmit more than 4x higher torque. Therefore the bars creating an unbeatable increased mixing effect in comparison to conventional stirring bars. The high energetic and long-term stable magnetic field does not have any demagnetization effect.

The concave design is made for a minimum of bearing surface and reliable rotation. Significantly higher rotation speed reachable! 300% less PTFE abrasion than comparable round shape stirring bars. The triangular shape raises the powerful shear force and increases the mixing effect at lower rotation speed.

The high quality PTFE cover is even and sealing the magnet, FDA-conform and steam sterilizable at 121°C.

2.7 Tips and hints to the topic stirring

The mixing flasks should be filled max. up to the middle (high speed range) resp. up to $\frac{3}{4}$ (low speed range).

Place one magnetic stirring bar in each stirring flask.

Place the stirring flasks right in the centre of the stirring point on the Stirring Hotplate resp. in one borehole of the Stirring Drybath.

In case the magnetic stirring bar turns in an unsteady or jerky way or bounces:

The interaction between the alternating magnetic field and the magnetic stirring bar is too high.

- Increase the speed or
- Use a smaller magnetic stirring bar or
- Decrease the stirring power.

In case the magnetic stirring bar will not be centred or leaves the centre permanently:

The interaction between the alternating magnetic field and the magnetic stirring bar is too low.

Or the stirring bar has a bottom that is uneven or too thick-walled.

Move the flask slightly back and forth and centre it again onto the stirring point of the stirrer surface.

- Reduce the speed or use a longer magnetic stirring bar or one with a larger diameter or
- Use a smaller flask with a thin-walled, even bottom or
- Reduce the filling amount in the flasks or
- Increase the stirring speed.

In case the stirring activity is too weak:

- Use commercial magnetic stirring bars with SamariumCobalt-core.
- Use a longer stirring bar or a stirring flask with smaller diameter.



We recommend using 2mag – ASTEROID stirring bars to increase the stirring performance.

3. Installation

3.1 Safety advice

Please ensure the following basic conditions prior to installation:



The wear-free inductive drive works with magnetism.

Cardiac pacemakers, data storage mediums, magnetic cards and other devices, which can be affected by magnetic fields, have to be kept away from the fields of the stirring unit as well as from the stirring bars.



The device must not be used in explosive rooms. The power supply unit and the magnetic stirrer must not be dipped in water or any cleaning solutions.



Your supply voltage has to comply with the label of the power supply unit.



To increase the operation safety, the power supply unit should be placed apart from chemical materials and reactions as well as away from thermal influences. For special requirements please contact info@2mag.de.



ATTENTION!

The power supply unit has to be disconnected, BEFORE you connect or disconnect the unit plug.



Always disconnect the power supply unit first before handling the connection cables.

3.2 Installation, connection to the magnetic stirrer

Step by step instruction (please also see image 3)



- Take the smaller wire (2) of the power supply unit (1) and connect the round plug (3) with the socket (4) at the backside of the magnetic stirrer (7).
- Connect the power cable (5) to the power supply unit (1) and afterwards to the power plug.
- The magnetic stirrer is now connected to the power supply unit and ready for operation.

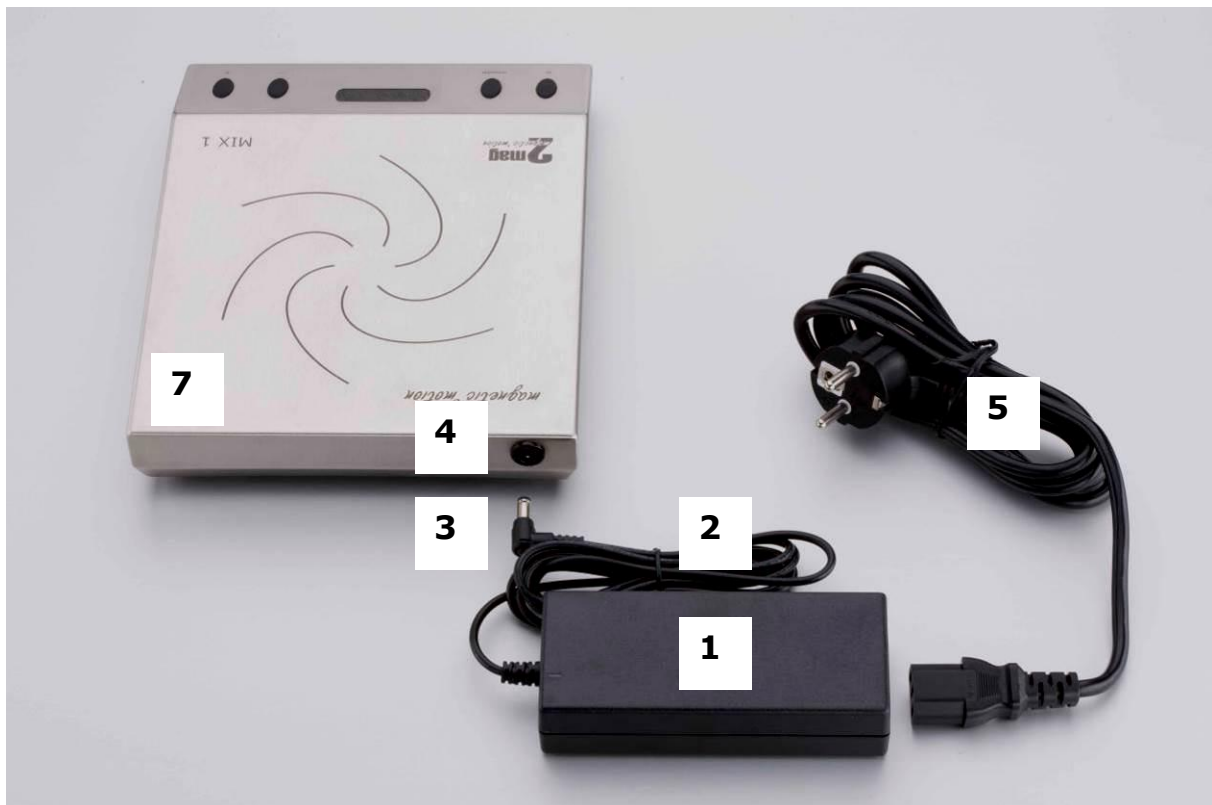

Image 3: Installation, rear side of the magnetic stirrer MIX 1

Description functional elements of control unit - backside

- 1 Power supply unit (100-240 volts)
- 2 Low voltage cable between power supply unit and magnetic stirrer
- 3 Low voltage plug
- 4 Low voltage socket at magnetic stirrer
- 5 Power cord

- 7 Magnetic stirrer

4. Operation of the magnetic stirrer MIX 4 MS

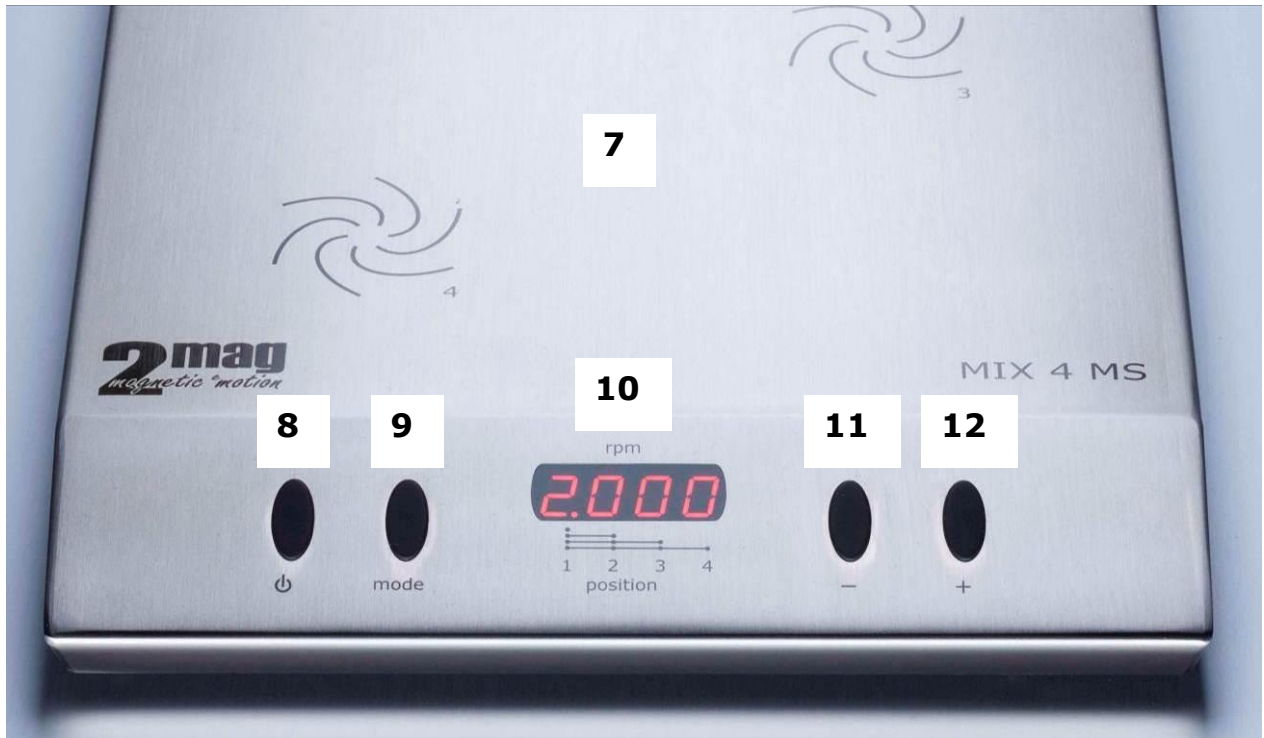

Image 4: Operating elements, magnetic stirrer MIX 4 MS

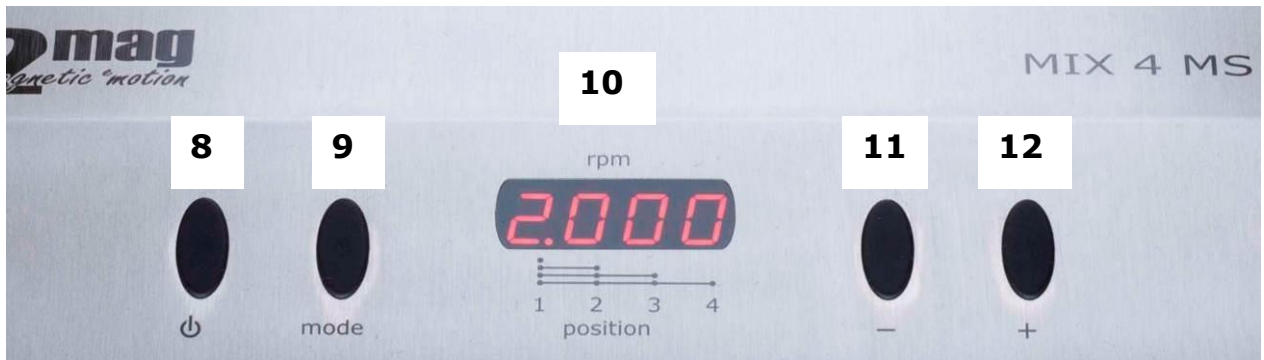

Image 5: Close-up – operation elements, magnetic stirrer MIX 4 MS

4.1 Description operating elements

7 Magnetic stirrer MIX 4 MS

Stirrer control

- 8 ON/OFF key for magnetic stirrer
- 9 MODE-key for selection (addressing) of stirring position 1-4
- 10 Display for speed and indication of addressed stirring position
- 11 MINUS-key (-) for reduction of stirrer speed
- 12 PLUS-key (+) for increase of the stirrer speed

Operating of the magnetic stirrer

After the cables have been installed correctly according to **Installation, connection to the magnetic stirrer**, the magnetic stirrer **MIX 4 MS** will be ready for operation.

4.2 Stirring operation and stirrer control

Turning On and Off

Please press the ON/OFF-key (8) once. The magnetic stirrer will be switched on by that. The current stirring speed will be shown in the display (10).

By pressing the ON/OFF-key (8) once more, the magnetic stirrer will be switched off again. The display indicator (10) expires.

SoftStart (always active – can not be switched off)

After the magnetic stirrer was switched on, the stirring bars in the flasks will first be caught, afterwards centred in the flask and then – to increase the operating safety – be smoothly accelerated to the set speed accurately.

Stirrer speed adjustment (basics)

The speed of the magnetic stirrer can be adjusted by pressing the MINUS- (11) resp. the PLUS-key (12).

The adjusted speed will be shown in the display (10) when the magnetic stirrer is switched on. The speed range can be adjusted between 100 and 2000 rpm in steps by 10.

By constantly pressing the MINUS- resp. the PLUS-keys, an accelerated adjustment of the speed can be achieved.

Addressing of stirring positions

The stirring positions 1/2/3/4 can be operated individually as well as all positions can be operated synchronous and simultaneously.

The individual control of the stirring positions 1-4 and "ALL" can be addressed by pressing the MODE-key (9) repeatedly.

Indication points – display

The display is based on 4x LED-segments with are showing the figures (0-9). At the segment corner down right is positioned an additional LED dot.

The sum of lighting dots is showing the number of the actual addressed stirring position. The speed of the addressed stirring position can be controlled by the MINUS- (11) resp. the PLUS-key (12) as well as the ON/OFF-function by the ON/OFF-key (8).

Example:

Two dots are lighting → stirring position 2 is addressed and can be control by MINUS- (11) resp. the PLUS-key (12) as well as the ON/OFF-key (8). Each stirring position can be set the stirring speed from 100-2000 rpm in steps by 10 and ON/OFF individually and separately.

Status ON – stirring positions

If the indication dots are lighting with a figure in the range 100-2000 rpm the addressed stirrer is switched on and working with the displayed speed.

If the indication dots are lighting without any figure the addressed stirrer is switched off.

Display, Magnetic Stirrer

The display (10) provides as described above a description of:

- Current stirring speed (always with switched on magnetic stirrer)
- Indication with help of the indication points which stirring position is addressed.
- To check, whether the magnetic stirrer is switched on. The display will not be illuminated in case the stirrer is switched off.

Furthermore following status can be shown:

„.” 1 indication dot is lighting - **stirring position 1** can be controlled by keys

„..” 2 indication dots are lighting - **stirring position 2** can be controlled by keys

„...” 3 indication dots are lighting - **stirring position 3** can be controlled by keys

„....” 4 indication dots are lighting: - **stirring position 4** can be controlled by keys

„_” (under score) of first segment is lighting: **synchronous operation – all stirring positions 1-4** can be controlled at one time by keys.



The wear-free inductive drive works with magnetism.

Cardiac pacemakers, data storage mediums, magnetic cards and other devices, which can be affected by magnetic fields, have to be kept away from the fields of the stirring unit as well as from the stirring bars.

4.3 Warning notices:



The magnetic stirrers MIX 4 MS is not suitable for using in water baths, incubators, ovens and humid atmosphere.

B Maintenance, Cleaning and Care



Do not use any cleaning agent or cleaning rag that is based on chlorine with metallic components or ammoniac.
These agents may harm the surface.



The magnetic stirrer must not be dipped in water or any cleaning solutions.

2mag devices are generally maintenance-free.

Due to their construction the **2mag** devices are very robust and designed for the professional daily use.

We recommend cleaning the devices' surfaces with e.g. cleaning agents containing tensides or isopropyl alcohol regularly.

BEFORE cleaning the surfaces, switch off the device with the power switch and pull out the power cable afterwards.

C Service case and customer service



During service, the device may only be opened by an authorized customer service.

In case of any defect on the device, please make sure to contact us first. We will be ready to offer help quickly and straightforward.

2mag AG

Schragenhofstr. 35 J
DE-80992 Muenchen
GERMANY

Fon: +49 89 14334252
Fax: +49 89 14334369
E-Mail: info@2mag.de
Web: www.2mag.de

Warranty:

Due to their construction, the **2mag** devices are very robust and designed for the professional daily use.

The magnetic drive works without any mechanically moved parts as e.g. belts, bearings or motors. Therefore a maximum of reliability within daily use is achieved.

Should in any case, despite our strict quality control, a system part not work without any fault, it can be repaired or exchanged by our customer service without any problems.

We guarantee 3 years warranty on all material and manufacturing defects.

D Errors

The magnetic stirring bar is turning in an unbalanced way:

There is no denying that magnetic stirring bars are aging in the course of time. This may happen by e.g. sterilizing, usage at high temperatures or causing stress (dropping down). The magnetism can be decreased by this. Separate out this stirring bar and exchange it by a new one.

The magnetic stirrer is not ready for operation despite the power connection has been made:

Please get into contact with us.

In general, we are ready to help you in case of problems.
For any enquiries, questions or suggestions please do not hesitate to contact us at info@2mag.de

E Technical details

Magnetic stirrer MIX 4 MS

	MIX 4 MS
Order no.	30404
Stirring points	4
Stirring point distance	140 mm
Stirring volume	1 – 3,000 ml
Speed range	100 – 2,000 rpm
Stirring power (max.)	28 (4x7) watts
Material housing	stainless-steel
Material sealing	PUR
Measurements (WxDxH)	245 x 425 x 38 mm
Weight	approx. 8.9 kg
Permitted operation conditions	-10 up to +50 °C (at 80% humidity)
Permitted storage conditions	-40 °C up to +70 °C, 10–95 %, 500-1060 hPa
Protection category	IP 64
Operating voltage	48 VDC
Electrical data	100-240 V / 50-60 Hz / 1.5 A

Accessory Magnetic Stirring Bar ASTEROID 40

	Magnetic Stirring Bar ASTEROID 40
Order no.	44040
Shape	triangle, concave
Material	PTFE
Measurement (DxL)	Ø 28 x 40 mm
Weight	ca. 0.06 kg



Image 6: Stirring bar ASTEROID 40

2mag AG
Schragenhofstr. 35 J
DE-80992 Muenchen
GERMANY

Fon: +49 89 14334252
Fax: +49 89 14334369
E-Mail: info@2mag.de
Web: www.2mag.de

EU-DECLARATION OF CONFORMITY FOR TECHNICAL DEVICES

(acc. to EU-guideline of the electromagnetic compatibility 2014/30/EU and the low voltage directive 2014/35/EU)

2mag AG
Schragenhofstraße 35 J
DE-80992 Muenchen
GERMANY

Hereby declares that the product

MIX 4 MS

is conform to the appropriate regulations of the EU-guideline of the electromagnetic compatibility (EU-guideline 2014/30/EU) as well as the low voltage directive (2014/35/EU) incl. their changes and the laws for the realization of the guideline into national law.

The declaration is valid under the following conditions:
The ambient conditions being stated in the operation manuals have to be adhered to.
This mainly applies to the supply with electric energy.

The following norms/standards were chosen to evaluate the finished products with regard to electromagnetic compatibility:

- DIN EN 61000-3-2
- DIN EN 61000-3-3
- DIN EN 61326-1
- DIN EN 60529

The following norms/standards were chosen to evaluate the finished products with regard to low voltage directive:

- DIN EN 61010-1
- DIN EN 61010-2-51

Muenchen, 20.10.2015

Signature: _____



Dr. Klaus Kaufmann (CTO)