

# 60PS SERIES

TUBING SIZE 3/8" - 3/4" | 3/8" FLOW POLYSULFONE

## UV-RESISTANT BLACK-OUT COLOR



See our website for Solid Models

**NEW**

### MATERIALS & CONSTRUCTION

- Bodies & Terminations: UV-Resistant Udel® Polysulfone
- Internal Valves: UV-Resistant Udel® Polysulfone
- Internal Valve Springs: 316 Stainless Steel
- Latch Spring: Stainless Steel
- O-rings: Peroxide-cured EPDM (others available)
- Thumb-latch: UV-Resistant Udel® Polysulfone

Please contact us for cleanroom produced versions.

Interchangeable with CPC® Colder HFC57 Series



### PERFORMANCE RATINGS

- Operating Pressure: Vacuum to 125 psi; (8.6bar)
- Temperature: -40°F to 280°F (-40°C to 138°C)
- Flow Capacity: 3/8" Size



The new 60PS-Black Series couplings offer 3/8" flow size and are manufactured from high performance thermoplastic Udel Polysulfone. The solid "black-out" color allows for the ability to color key applications and provides a greater UV radiation resistance than 60PS-White couplings, in addition to their inherent stability at high temperatures. Available in both valved and non-valved configurations, these quick disconnect couplings are easy to use with their more robust thumb latch. They are manufactured to maintain a long service life in a variety of applications. The 60PS-Black Series couplings interconnect with all other 60 series couplings as well as other similar industry thumb-latch type high flow couplings.

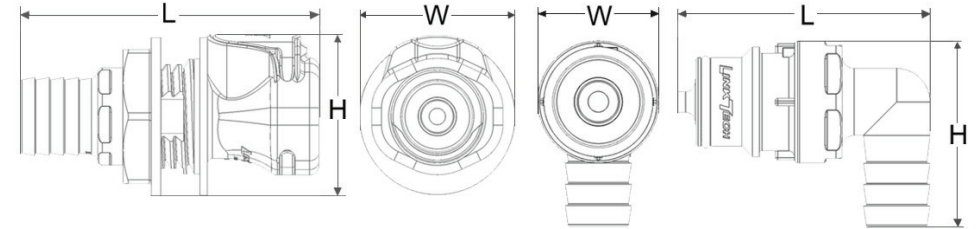

Reference Dimensions (Scaled Down): L = Length, W = Width, H = Height

### Panel Mount Dimensions

	PANEL OPENING	MAX PANEL THICKNESS	MIN PANEL THICKNESS
SOCKETS	See Drawing	0.3"	0.03"
PLUGS	1.21"	0.3"	0.03"

PANEL NUT HEX SIZE
1.375"

PART NUMBER GUIDE EXAMPLE:  
**60 PS V - SE 2 - 08BLK**

FLOW SIZE OR LATCH TYPE | MATERIAL | VALVE | CONFIG. AND O-RING | TYPE | CONNECTION SIZE | COLOR OPTION

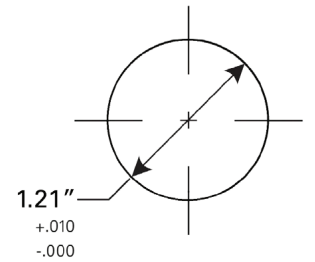

### Flow Rates

The data below shows the liquid flow rates for LinkTech couplings. Each coupling combination was tested at 70° F (21°C).

Specific coupling combination flow rates can be determined by using this formula:

$$Q = C_v \sqrt{\frac{\Delta P}{S}}$$

Q = Flow rate in gallons per minute  
 C<sub>v</sub> = Average flow rates (see chart)  
 ΔP = Pressure drop across coupling (psi)  
 S = Specific gravity of liquid.

### C<sub>v</sub> Values for 60PS Series Couplings

SOCKETS	60PS-PE2-06 BLK	60PSV-PE2-06 BLK	60PS-PE2-08 BLK	60PSV-PE2-08 BLK	60PS-PE4-06 BLK	60PSV-PE4-06 BLK	60PS-PE4-08 BLK	60PSV-PE4-08 BLK	60PS-PE1-06 BLK	60PSV-PE1-06 BLK	60PS-PE1-08 BLK	60PSV-PE1-08 BLK	60PS-PE2-12 BLK	60PSV-PE2-12 BLK
60PSV-SE1-06BLK	1.27	1.27	1.62	1.51	1.14	1.14	1.46	1.36	1.80	1.58	1.70	1.65	-	-
60PSV-SE1-08BLK	1.28	1.34	1.62	1.51	1.15	1.24	1.46	1.36	1.81	1.54	1.72	1.56	-	-
60PSV-SE3-06BLK	1.07	1.00	1.17	1.14	0.96	0.90	1.05	1.03	1.33	1.26	1.30	1.24	-	-
60PSV-SE3-08BLK	1.25	1.23	1.61	1.52	1.13	1.11	1.45	1.37	1.79	1.60	1.68	1.56	-	-
60PSV-SE2-06BLK	1.07	1.00	1.17	1.14	0.96	0.90	1.05	1.03	1.33	1.26	1.30	1.24	-	-
60PSV-SE2-08BLK	1.25	1.23	1.61	1.52	1.13	1.11	1.45	1.37	1.79	1.60	1.68	1.56	-	-
60PS-S2-12BLK	-	-	-	-	-	-	-	-	-	-	-	-	3.94	-
60PSV-SE2-12BLK	-	-	-	-	-	-	-	-	-	-	-	-	-	2.04

60PS Series Air Flow

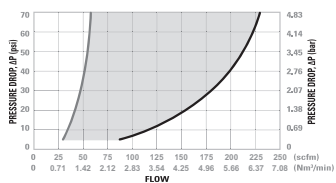

60PS Series Water Flow

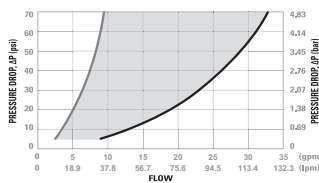

60PS Series Temperature

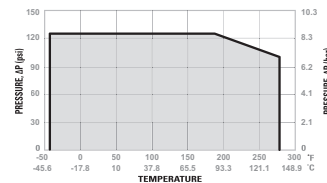

Valved Socket & Plug



Valved & Non-Valved Coupling Set



Non-Valved Socket & Plug





# 60PS

Tubing Size 3/8" - 3/4"  
3/8" Flow Polysulfone



### MALE THREAD SOCKET

NON-VALVED	VALVED	THREAD SIZE	LENGTH	WIDTH	HEIGHT
60PS-S1-06BLK	60PSV-SE1-06BLK	3/8" NPT	2.78" (71mm)	1.36" (35mm)	1.44" (37mm)
60PS-S1-08BLK	60PSV-SE1-08BLK	1/2" NPT	2.93" (74mm)	1.36" (35mm)	1.44" (37mm)



### IN-LINE HOSE BARB SOCKET

NON-VALVED	VALVED	TUBE SIZE	METRIC TUBE	LENGTH	WIDTH	HEIGHT
60PS-S2-06BLK	60PSV-SE2-06BLK	3/8" ID	9.5mm ID	2.82" (72mm)	1.36" (35mm)	1.44" (37mm)
60PS-S2-08BLK	60PSV-SE2-08BLK	1/2" ID	12.7mm ID	2.92" (74mm)	1.36" (35mm)	1.44" (37mm)
60PS-S2-12BLK	60PSV-SE2-12BLK	3/4" ID	19.0mm ID	2.97" (75mm)	1.36" (35mm)	1.44" (37mm)



### PANEL MOUNT HOSE BARB SOCKET (GASKET SEAL INCLUDED)

NON-VALVED	VALVED	TUBE SIZE	METRIC TUBE	LENGTH	WIDTH	HEIGHT
60PS-S3-06BLK	60PSV-SE3-06BLK	3/8" ID	9.5mm ID	2.90" (74mm)	1.62" (41mm)	1.65" (42mm)
60PS-S3-08BLK	60PSV-SE3-08BLK	1/2" ID	12.7mm ID	3.07" (78mm)	1.62" (41mm)	1.65" (42mm)
60PS-S3-12BLK	60PSV-SE3-12BLK	3/4" ID	19.0mm ID	3.12" (79mm)	1.62" (41mm)	1.65" (42mm)



### PANEL MOUNT HOSE BARB ELBOW SOCKET (GASKET SEAL INCLUDED)

NON-VALVED	VALVED	TUBE SIZE	METRIC TUBE	LENGTH	WIDTH	HEIGHT
60PS-S2-06BLK	60PSV-SE22-06BLK	3/8" ID	9.5mm ID	2.96" (75mm)	1.62" (41mm)	1.73" (44mm)
60PS-S2-08BLK	60PSV-SE22-08BLK	1/2" ID	12.7mm ID	2.96" (75mm)	1.62" (41mm)	1.83" (46mm)



## PART NUMBER GUIDE EXAMPLE: 60 PS V - SE 2 - 08BLK

\*External product dimensions are the same with or without a shut off valve

FLOW SIZE OR LATCH TYPE	MATERIAL	VALVE	CONFIG. AND O-RING	TYPE	CONNECTION SIZE	COLOR OPTION
60	PS	V	-	SE 2	-	08BLK



# NON-VALVED



### MALE THREAD PLUG

NON-VALVED	THREAD SIZE	LENGTH	WIDTH	HEIGHT
60PS-PE1-06BLK	3/8" NPT	2.82" (72mm)	1.14" (29mm)	1.00" (25mm)
60PS-PE1-08BLK	1/2" NPT	2.82" (72mm)	1.14" (29mm)	1.00" (25mm)



### IN-LINE HOSE BARB PLUG

NON-VALVED	TUBE SIZE	METRIC TUBE	LENGTH	WIDTH	HEIGHT
60PS-PE2-06BLK	3/8" ID	9.5mm ID	1.91" (49mm)	1.00" (25mm)	1.00" (25mm)
60PS-PE2-08BLK	1/2" ID	12.7mm ID	2.01" (51mm)	1.00" (25mm)	1.00" (25mm)
60PS-PE2-12BLK	3/4" ID	19.0mm ID	2.01" (51mm)	1.00" (25mm)	1.00" (25mm)



### PANEL MOUNT HOSE BARB PLUG (GASKET SEAL INCLUDED)

NON-VALVED	TUBE SIZE	METRIC TUBE	LENGTH	WIDTH	HEIGHT
60PS-PE3-06BLK	3/8" ID	9.5mm ID	2.78" (71mm)	1.62" (41mm)	1.62" (41mm)
60PS-PE3-08BLK	1/2" ID	12.7mm ID	2.88" (73mm)	1.62" (41mm)	1.62" (41mm)
60PS-PE3-12BLK	3/4" ID	19.0mm ID	2.93" (74mm)	1.62" (41mm)	1.62" (41mm)



### PANEL MOUNT HOSE BARB PLUG (GASKET SEAL INCLUDED)

NON-VALVED	TUBE SIZE	METRIC TUBE	LENGTH	WIDTH	HEIGHT
60PS-PE22-06BLK	3/8" ID	9.5mm ID	2.86" (73mm)	1.62" (41mm)	1.73" (44mm)
60PS-PE22-08BLK	1/2" ID	12.7mm ID	2.86" (73mm)	1.62" (41mm)	1.83" (46mm)



### ELBOW HOSE BARB PLUG

NON-VALVED	TUBE SIZE	METRIC TUBE	LENGTH	WIDTH	HEIGHT
60PS-PE4-06BLK	3/8" ID	9.5mm ID	1.98" (50mm)	1.00" (25mm)	1.43" (36mm)
60PS-PE4-08BLK	1/2" ID	12.7mm ID	1.98" (50mm)	1.00" (25mm)	1.53" (39mm)

# VALVED



### MALE THREAD PLUG

VALVED	THREAD SIZE	LENGTH	WIDTH	HEIGHT
60PSV-PE1-06BLK	3/8" NPT	2.92" (74mm)	1.14" (29mm)	1.00" (25mm)
60PSV-PE1-08BLK	1/2" NPT	2.92" (74mm)	1.14" (29mm)	1.00" (25mm)



### IN-LINE HOSE BARB PLUG

VALVED	TUBE SIZE	METRIC TUBE	LENGTH	WIDTH	HEIGHT
60PSV-PE2-06BLK	3/8" ID	9.5mm ID	2.05" (52mm)	1.00" (25mm)	1.00" (25mm)
60PSV-PE2-08BLK	1/2" ID	12.7mm ID	2.15" (55mm)	1.00" (25mm)	1.00" (25mm)
60PSV-PE2-12BLK	3/4" ID	19.0mm ID	2.20" (56mm)	1.00" (25mm)	1.00" (25mm)



### PANEL MOUNT HOSE BARB PLUG (GASKET SEAL INCLUDED)

VALVED	TUBE SIZE	METRIC TUBE	LENGTH	WIDTH	HEIGHT
60PSV-PE3-06BLK	3/8" ID	9.5mm ID	2.92" (74mm)	1.62" (41mm)	1.62" (41mm)
60PSV-PE3-08BLK	1/2" ID	12.7mm ID	3.02" (77mm)	1.62" (41mm)	1.62" (41mm)
60PSV-PE3-12BLK	3/4" ID	19.0mm ID	3.07" (78mm)	1.62" (41mm)	1.62" (41mm)



### PANEL MOUNT HOSE BARB PLUG (GASKET SEAL INCLUDED)

VALVED	TUBE SIZE	METRIC TUBE	LENGTH	WIDTH	HEIGHT
60PSV-PE22-06BLK	3/8" ID	9.5mm ID	3.00" (76mm)	1.62" (41mm)	1.73" (44mm)
60PSV-PE22-08BLK	1/2" ID	12.7mm ID	3.00" (76mm)	1.62" (41mm)	1.83" (46mm)



### ELBOW HOSE BARB PLUG

VALVED	TUBE SIZE	METRIC TUBE	LENGTH	WIDTH	HEIGHT
60PSV-PE4-06BLK	3/8" ID	9.5mm ID	2.12" (54mm)	1.00" (25mm)	1.43" (36mm)
60PSV-PE4-08BLK	1/2" ID	12.7mm ID	2.12" (54mm)	1.00" (25mm)	1.53" (39mm)