

42AB SERIES

TUBING SIZE 1/8" | 3/32" FLOW ABS MATERIAL



PERFORMANCE RATINGS

- Operating Pressure: Vacuum to 120psi; (8.3bar)
- Temperature: -40°F to 180°F; (-40°C to 82°C)
- Flow Capacity: 3/32" Size

MATERIALS & CONSTRUCTION

- Bodies & Terminations: Medical Grade ABS
- O-rings: Buna-N
- Thumb-latch: Stainless Steel
- External Springs & Pins: Stainless Steel

Please contact us for cleanroom produced versions.



Interchangeable with CPC® Colder Twin Tube™ Series



DUAL TUBE TECHNOLOGY

42AB Series Dual Tube couplings offer 3/32" flow capacity and are manufactured from medical grade thermoplastic ABS material. The dual free flow path technology allows two separate fluid lines to run simultaneously all in one coupling. The thumb-latch release creates a simple one hand disconnection, for a quick disconnect, free rotating coupling. 42AB Dual Tube couplings interconnect with other similar industry Twin thumb-latch type couplings.

42AB Series Water Flow

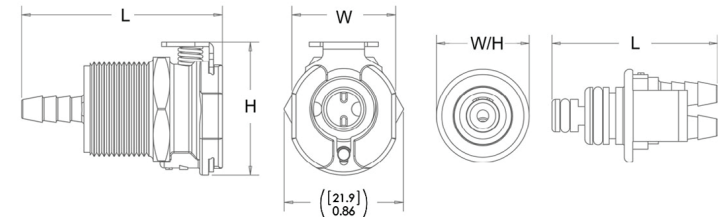
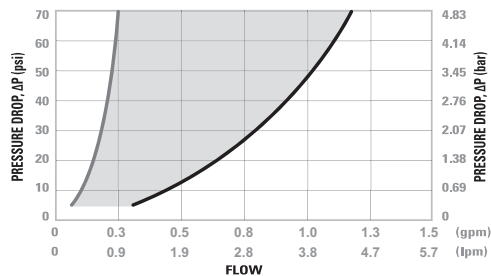

*Illustrations are actual size of product.

Reference Dimensions: L = Length, W = Width, H = Height

Panel Mount Dimensions

PANEL NUT HEX SIZE	PANEL NUT THREAD
13/16"	11/16" - 24 UNS

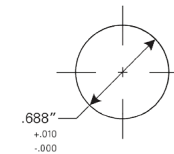

42AB

Tubing Size 1/8"
3/32" Flow ABS Material

PANEL MOUNT HOSE BARB SOCKET					
NON-VALVED	TUBE SIZE	METRIC TUBE	LENGTH	WIDTH	HEIGHT
42AB-S3-02	1/8" ID	3.2mm ID	1.45" (37mm)	0.75" (19mm)	1.00" (25mm)

IN-LINE HOSE BARB PLUG					
NON-VALVED	TUBE SIZE	METRIC TUBE	LENGTH	WIDTH	HEIGHT
42AB-PB2-02	1/8" ID	3.2mm ID	1.26" (32mm)	0.70" (18mm)	0.70" (18mm)