

40CB SERIES

TUBING SIZE 1/4" - 3/8" | 1/4" FLOW CHROME BRASS



PERFORMANCE RATINGS

- Operating Pressure: Vacuum to 250psi; (17.3bar)
- Temperature: -40°F to 180°F; (-40°C to 82°C)
- Flow Capacity: 1/4" Size

MATERIALS & CONSTRUCTION

- Bodies & Terminations: Food Grade Chrome/Brass
- Internal Valves: Acetal (POM)
- Internal Valve Springs: 316 Stainless Steel
- O-rings: Buna-N (others available)
- Thumb-latch: Stainless Steel
- External Springs & Pins: Stainless Steel



Interchangeable with CPC® - Colder LC Series



Please contact us for NSF compliant and cleanroom produced versions.

LEGACY METAL LATCH

Produced in food grade chrome plated brass, these 1/4" flow size couplings are more durable and withstand higher pressures. They are available with internal shut-off valves or straight through. All 40CB couplings interconnect with all other 40AC and 40PP couplings as well as other similar industry thumb-latch type couplings.

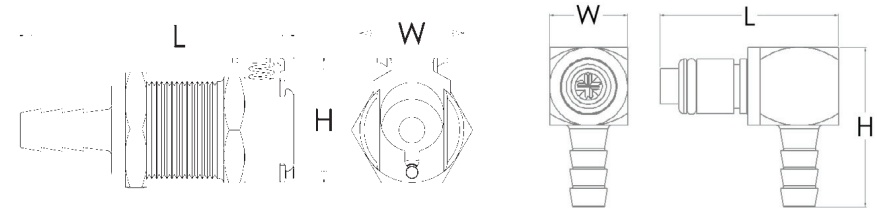

*Illustrations are actual size of product.

Reference Dimensions: L = Length, W = Width, H = Height

Panel Mount Dimensions

| | PANEL OPENING | MAX PANEL THICKNESS | MIN PANEL THICKNESS |
|---------|---------------|---------------------|---------------------|
| SOCKETS | 0.688" | 0.5" | 0.05" |
| PLUGS | 0.688" | 0.3" | 0.05" |

| PANEL NUT HEX SIZE | PANEL NUT THREAD |
|--------------------|------------------|
| 13/16" | 11/16" - 24 UNS |

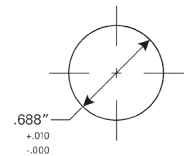

PART NUMBER GUIDE EXAMPLE:

40 CB V - PB 2 - 04

FLOW SIZE OR LATCH TYPE | MATERIAL | VALVE | CONFIG. AND O-RINGS | TYPE | CONNECTION SIZE

Flow Rates

The data below shows the liquid flow rates for LinkTech couplings. Each coupling combination was tested at 70° F (21°C).

Specific coupling combination flow rates can be determined by using this formula:

$$Q = C_v \sqrt{\frac{\Delta P}{S}}$$

Q = Flow rate in gallons per minute
 C_v = Average flow rates (see chart)
 ΔP = Pressure drop across coupling (psi)
 S = Specific gravity of liquid.

C_v Values for 40CB Series Couplings

| SOCKETS | 40CBV-PB2-04 | 40CB-PB2-04 | 40CBV-PB2-06 | 40CB-PB2-06 | 40CBV-PB9-04 | 40CB-PB9-04 | 40CBV-PB9-06 | 40CB-PB9-06 | 40CBV-PB1-04 | 40CB-PB1-04 | 40CBV-PB1-06 | 40CB-PB1-06 |
|--------------|--------------|-------------|--------------|-------------|--------------|-------------|--------------|-------------|--------------|-------------|--------------|-------------|
| 40CBV-SB2-04 | 0.42 | 0.58 | 0.45 | 0.78 | 0.31 | 0.38 | 0.45 | 0.60 | 0.43 | 0.79 | 0.45 | 0.75 |
| 40CB-S2-04 | 0.52 | 0.95 | 0.70 | 1.00 | 0.38 | 0.39 | 0.55 | 0.87 | 0.65 | 0.95 | 0.65 | 1.00 |
| 40CBV-SB2-06 | 0.43 | 0.63 | 0.50 | 0.89 | 0.33 | 0.39 | 0.62 | 0.50 | 0.45 | 0.95 | 0.50 | 0.92 |
| 40CB-S2-06 | 0.53 | 0.95 | 0.80 | 1.40 | 0.38 | 0.39 | 0.57 | 1.00 | 0.70 | 1.40 | 0.73 | 1.40 |
| 40CBV-SB3-04 | 0.42 | 0.58 | 0.45 | 0.78 | 0.31 | 0.38 | 0.45 | 0.60 | 0.43 | 0.79 | 0.45 | 0.75 |
| 40CB-S3-04 | 0.52 | 0.95 | 0.70 | 1.00 | 0.38 | 0.39 | 0.55 | 0.87 | 0.65 | 0.95 | 0.65 | 1.00 |
| 40CBV-SB3-06 | 0.43 | 0.63 | 0.50 | 0.89 | 0.33 | 0.39 | 0.56 | 0.61 | 0.45 | 0.95 | 0.50 | 0.92 |
| 40CB-S3-06 | 0.53 | 0.95 | 0.80 | 1.40 | 0.38 | 0.39 | 0.57 | 1.00 | 0.70 | 1.40 | 0.73 | 1.40 |
| 40CBV-SB1-04 | 0.41 | 0.65 | 0.50 | 0.81 | 0.31 | 0.35 | 0.48 | 0.74 | 0.45 | 0.80 | 0.45 | 0.80 |
| 40CB-S1-04 | 0.56 | 0.84 | 0.83 | 1.40 | 0.35 | 0.40 | 0.58 | 1.04 | 0.75 | 1.40 | 0.78 | 1.40 |
| 40CBV-SB1-06 | 0.43 | 0.70 | 0.50 | 1.03 | 0.30 | 0.36 | 0.59 | 0.60 | 0.45 | 0.97 | 0.48 | 1.00 |
| 40CB-S1-06 | 0.57 | 0.84 | 0.82 | 1.40 | 0.35 | 0.40 | 0.60 | 1.05 | 0.75 | 1.40 | 0.75 | 1.40 |

40CB Series Air Flow

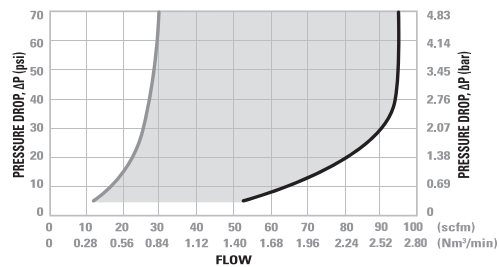

40CB Series Water Flow

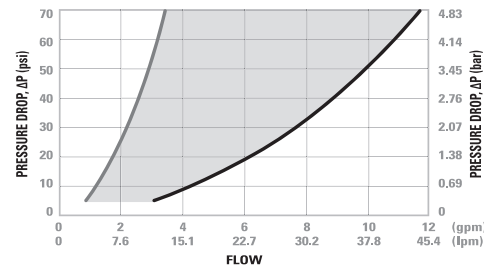

Valved Socket & Plug | Valved & Non-Valved Coupling Set | Non-Valved Socket & Plug



Interchangeable with
CPC® Colder LC Series



40CB

Tubing Size 1/4" - 3/8"
1/4" Flow Chrome Brass

| MALE THREAD SOCKET | | | | | | |
|--------------------|------------------|-------------|---------------|--------------|-------------|--|
| NON-VALVED | VALVED | THREAD SIZE | LENGTH | WIDTH | HEIGHT | |
| 40CB-S1-04 | 40CBV-SB1-04 | 1/4" NPT | 1.15" (29 mm) | 0.86" (22mm) | 0.9" (23mm) | |
| 40CB-S1-04BSPT | 40CBV-SB1-04BSPT | 1/4" BSPT | 1.15" (29 mm) | 0.86" (22mm) | 0.9" (23mm) | |
| 40CB-S1-06 | 40CBV-SB1-06 | 3/8" NPT | 1.15" (29 mm) | 0.86" (22mm) | 0.9" (23mm) | |
| 40CB-S1-06BSPT | 40CBV-SB1-06BSPT | 3/8" BSPT | 1.15" (29 mm) | 0.86" (22mm) | 0.9" (23mm) | |

| IN-LINE HOSE BARB SOCKET | | | | | | |
|--------------------------|--------------|-----------|-------------|--------------|-------------|-------------|
| NON-VALVED | VALVED | TUBE SIZE | METRIC TUBE | LENGTH | WIDTH | HEIGHT |
| 40CB-S2-04 | 40CBV-SB2-04 | 1/4" ID | 6.4mm ID | 1.95" (50mm) | .75" (19mm) | .90" (23mm) |
| 40CB-S2-05 | 40CBV-SB2-05 | 5/16" ID | 7.9mm ID | 2.0" (51mm) | .75" (19mm) | .90" (23mm) |
| 40CB-S2-06 | 40CBV-SB2-06 | 3/8" ID | 9.5mm ID | 2.0" (51mm) | .75" (19mm) | .90" (23mm) |

| IN-LINE PTF SOCKET | | | | | | |
|--------------------|--------------|------------------|--------------------|--------------|-------------|-------------|
| NON-VALVED | VALVED | TUBE SIZE | METRIC TUBE | LENGTH | WIDTH | HEIGHT |
| 40CB-S9-04 | 40CBV-SB9-04 | 1/4" OD, .17" ID | 6.4mm OD, 4.3mm ID | 1.87" (47mm) | .75" (19mm) | .90" (23mm) |
| 40CB-S9-06 | 40CBV-SB9-06 | 3/8" OD, .25" ID | 9.5mm OD, 6.4mm ID | 1.95" (50mm) | .75" (19mm) | .90" (23mm) |

| PANEL MOUNT HOSE BARB SOCKET | | | | | | |
|------------------------------|--------------|-----------|-------------|--------------|-------------|-------------|
| NON-VALVED | VALVED | TUBE SIZE | METRIC TUBE | LENGTH | WIDTH | HEIGHT |
| 40CB-S3-04 | 40CBV-SB3-04 | 1/4" ID | 6.4mm ID | 1.95" (50mm) | .86" (22mm) | .90" (23mm) |
| 40CB-S3-05 | 40CBV-SB3-05 | 5/16" ID | 7.9mm ID | 2.0" (51mm) | .86" (22mm) | .90" (23mm) |
| 40CB-S3-06 | 40CBV-SB3-06 | 3/8" ID | 9.5mm ID | 2.0" (51mm) | .86" (22mm) | .90" (23mm) |

Interchangeable with
CPC® Colder LC Series



| PANEL MOUNT PTF SOCKET | | | | | | |
|------------------------|--------------|------------------|--------------------|--------------|-------------|-------------|
| NON-VALVED | VALVED | TUBE SIZE | METRIC TUBE | LENGTH | WIDTH | HEIGHT |
| 40CB-S8-04 | 40CBV-SB8-04 | 1/4" OD, .17" ID | 6.4mm OD, 4.3mm ID | 1.87" (47mm) | .86" (22mm) | .90" (23mm) |
| 40CB-S8-06 | 40CBV-SB8-06 | 3/8" OD, .25" ID | 9.5mm OD, 6.4mm ID | 1.95" (50mm) | .86" (22mm) | .90" (23mm) |

| PANEL MOUNT MALE THREAD SOCKET | | | | | | |
|--------------------------------|---------------|-------------|-------------|-------------|-------------|--|
| NON-VALVED | VALVED | THREAD SIZE | LENGTH | WIDTH | HEIGHT | |
| 40CB-S12-04 | 40CBV-SB12-04 | 1/4" NPT | .87" (22mm) | .90" (23mm) | .80" (20mm) | |

| FEMALE THREAD SOCKET | | | | | | |
|----------------------|---------------|-------------|-----------------------------|--------------|-------------|--|
| NON-VALVED | VALVED | THREAD SIZE | L(OVIV) | WIDTH | HEIGHT | |
| 40CB-S13-04 | 40CBV-SB13-04 | 1/4" NPT | 1.15" (28mm) / 1.68" (43mm) | 0.87" (22mm) | 0.9" (23mm) | |

| MALE THREAD SOCKET (GASKET SEAL INCLUDED) | | | | | | |
|---|-------------|--------------|-------------|-------------|--|--|
| NON-VALVED | THREAD SIZE | LENGTH | WIDTH | HEIGHT | | |
| 40CB-S3557 | 15/16-27 | 1.23" (31mm) | .95" (24mm) | .99" (25mm) | | |
| 40CB-S3562 | M24 X 1 | 1.23" (31mm) | .95" (24mm) | .99" (25mm) | | |

| FEMALE THREAD SOCKET (GASKET SEAL INCLUDED) | | | | | | |
|---|-------------|--------------|-------------|--------------|--|--|
| NON-VALVED | THREAD SIZE | LENGTH | WIDTH | HEIGHT | | |
| 40CB-S3559 | 55/64-27 | 1.21" (31mm) | .97" (25mm) | 1.01" (26mm) | | |
| 40CB-S3564 | M22 X 1 | 1.21" (31mm) | .97" (25mm) | 1.01" (26mm) | | |



*External product dimensions are the same with or without a shut off valve

PART NUMBER GUIDE EXAMPLE:

40 CB V - PB 2 - 04

|
 FLOW SIZE OR LATCH TYPE MATERIAL VALVE CONFIG. AND O-RING TYPE CONNECTION SIZE

Interchangeable with
CPC® Colder LC Series



NON-VALVED



MALE THREAD PLUG

| NON-VALVED | THREAD SIZE | LENGTH | WIDTH | HEIGHT |
|-----------------|-------------|--------------|-------------|-------------|
| 40CB-PB1-04 | 1/4" NPT | 1.25" (32mm) | .63" (16mm) | .63" (16mm) |
| 40CB-PB1-04BSPT | 1/4" BSPT | 1.25" (32mm) | .63" (16mm) | .63" (16mm) |
| 40CB-PB1-06 | 3/8" NPT | 1.25" (32mm) | .75" (19mm) | .75" (19mm) |
| 40CB-PB1-06BSPT | 3/8" BSPT | 1.25" (32mm) | .75" (19mm) | .75" (19mm) |



FEMALE THREAD PLUG

| NON-VALVED | THREAD SIZE | LENGTH | WIDTH | HEIGHT |
|--------------|-------------|--------------|-------------|-------------|
| 40CB-PB13-04 | 1/4" NPT | 1.25" (32mm) | .63" (16mm) | .63" (16mm) |



IN-LINE HOSE BARB PLUG

| NON-VALVED | TUBE SIZE | METRIC TUBE | LENGTH | WIDTH | HEIGHT |
|-------------|-----------|-------------|--------------|-------------|-------------|
| 40CB-PB2-04 | 1/4" ID | 6.4mm ID | 1.30" (33mm) | .63" (16mm) | .63" (16mm) |
| 40CB-PB2-05 | 5/16" ID | 7.9mm ID | 1.30" (33mm) | .63" (16mm) | .63" (16mm) |
| 40CB-PB2-06 | 3/8" ID | 9.5mm ID | 1.30" (33mm) | .63" (16mm) | .63" (16mm) |



IN-LINE PTF PLUG

| NON-VALVED | TUBE SIZE | METRIC TUBE | LENGTH | WIDTH | HEIGHT |
|-------------|------------------|--------------------|--------------|-------------|-------------|
| 40CB-PB9-04 | 1/4" OD, .17" ID | 6.4mm OD, 4.3mm ID | 1.21" (31mm) | .63" (16mm) | .63" (16mm) |
| 40CB-PB9-06 | 3/8" OD, .25" ID | 9.5mm OD, 6.4mm ID | 1.34" (34mm) | .63" (16mm) | .63" (16mm) |



PANEL MOUNT HOSE BARB PLUG

| NON-VALVED | TUBE SIZE | METRIC TUBE | LENGTH | WIDTH | HEIGHT |
|-------------|-----------|-------------|--------------|-------------|-------------|
| 40CB-PB3-04 | 1/4" ID | 6.4mm ID | 1.32" (49mm) | .75" (19mm) | .75" (19mm) |
| 40CB-PB3-05 | 5/16" ID | 7.9mm ID | 1.36" (50mm) | .75" (19mm) | .75" (19mm) |
| 40CB-PB3-06 | 3/8" ID | 9.5mm ID | 1.34" (49mm) | .75" (19mm) | .75" (19mm) |



PANEL MOUNT PTF PLUG

| NON-VALVED | TUBE SIZE | METRIC TUBE | LENGTH | WIDTH | HEIGHT |
|-------------|------------------|--------------------|--------------|-------------|-------------|
| 40CB-PB8-04 | 1/4" OD, .17" ID | 6.4mm OD, 4.3mm ID | 1.82" (46mm) | .75" (19mm) | .75" (19mm) |
| 40CB-PB8-06 | 3/8" OD, .25" ID | 9.5mm OD, 6.4mm ID | 1.91" (49mm) | .75" (19mm) | .75" (19mm) |



ELBOW HOSE BARB PLUG

| NON-VALVED | TUBE SIZE | METRIC TUBE | LENGTH | WIDTH | HEIGHT |
|-------------|-----------|-------------|--------------|-------------|--------------|
| 40CB-PB4-04 | 1/4" ID | 6.4mm ID | 1.28" (33mm) | .63" (16mm) | 1.28" (33mm) |
| 40CB-PB4-06 | 3/8" ID | 9.5mm ID | 1.28" (33mm) | .63" (16mm) | 1.28" (33mm) |



ELBOW PTF PLUG

| NON-VALVED | TUBE SIZE | METRIC TUBE | LENGTH | WIDTH | HEIGHT |
|--------------|------------------|--------------------|--------------|-------------|--------------|
| 40CB-PB10-04 | 1/4" OD, .17" ID | 6.4mm OD, 4.3mm ID | 1.29" (33mm) | .63" (16mm) | 1.28" (33mm) |
| 40CB-PB10-06 | 3/8" OD, .25" ID | 9.5mm OD, 6.4mm ID | 1.29" (33mm) | .63" (16mm) | 1.28" (33mm) |

Interchangeable with
CPC® Colder LC Series



VALVED



MALE THREAD PLUG

| NON-VALVED | THREAD SIZE | LENGTH | WIDTH | HEIGHT |
|------------------|-------------|--------------|-------------|-------------|
| 40CBV-PB1-04 | 1/4" NPT | 1.55" (39mm) | .63" (16mm) | .63" (16mm) |
| 40CBV-PB1-04BSPT | 1/4" BSPT | 1.55" (39mm) | .63" (16mm) | .63" (16mm) |
| 40CBV-PB1-06 | 3/8" NPT | 1.55" (39mm) | .75" (19mm) | .75" (19mm) |
| 40CBV-PB1-06BSPT | 3/8" BSPT | 1.55" (39mm) | .75" (19mm) | .75" (19mm) |



FEMALE THREAD PLUG

| NON-VALVED | THREAD SIZE | LENGTH | WIDTH | HEIGHT |
|---------------|-------------|--------------|-------------|-------------|
| 40CBV-PB13-04 | 1/4" NPT | 1.90" (48mm) | .63" (16mm) | .63" (16mm) |



IN-LINE HOSE BARB PLUG

| NON-VALVED | TUBE SIZE | METRIC TUBE | LENGTH | WIDTH | HEIGHT |
|--------------|-----------|-------------|--------------|-------------|-------------|
| 40CBV-PB2-04 | 1/4" ID | 6.4mm ID | 1.85" (47mm) | .63" (16mm) | .63" (16mm) |
| 40CBV-PB2-05 | 5/16" ID | 7.9mm ID | 1.85" (47mm) | .63" (16mm) | .63" (16mm) |
| 40CBV-PB2-06 | 3/8" ID | 9.5mm ID | 1.85" (47mm) | .63" (16mm) | .63" (16mm) |



IN-LINE PTF PLUG

| NON-VALVED | TUBE SIZE | METRIC TUBE | LENGTH | WIDTH | HEIGHT |
|--------------|------------------|--------------------|--------------|-------------|-------------|
| 40CBV-PB9-04 | 1/4" OD, .17" ID | 6.4mm OD, 4.3mm ID | 1.92" (49mm) | .63" (16mm) | .63" (16mm) |
| 40CBV-PB9-06 | 3/8" OD, .25" ID | 9.5mm OD, 6.4mm ID | 2.05" (52mm) | .63" (16mm) | .63" (16mm) |



PANEL MOUNT HOSE BARB PLUG

| NON-VALVED | TUBE SIZE | METRIC TUBE | LENGTH | WIDTH | HEIGHT |
|--------------|-----------|-------------|--------------|-------------|-------------|
| 40CBV-PB3-04 | 1/4" ID | 6.4mm ID | 2.06" (52mm) | .75" (19mm) | .75" (19mm) |
| 40CBV-PB3-05 | 5/16" ID | 7.9mm ID | 2.10" (53mm) | .75" (19mm) | .75" (19mm) |
| 40CBV-PB3-06 | 3/8" ID | 9.5mm ID | 2.08" (53mm) | .75" (19mm) | .75" (19mm) |



PANEL MOUNT PTF PLUG

| NON-VALVED | TUBE SIZE | METRIC TUBE | LENGTH | WIDTH | HEIGHT |
|--------------|------------------|--------------------|--------------|-------------|-------------|
| 40CBV-PB8-04 | 1/4" OD, .17" ID | 6.4mm OD, 4.3mm ID | 1.95" (50mm) | .75" (19mm) | .75" (19mm) |
| 40CBV-PB8-06 | 3/8" OD, .25" ID | 9.5mm OD, 6.4mm ID | 2.05" (52mm) | .75" (19mm) | .75" (19mm) |



ELBOW HOSE BARB PLUG

| NON-VALVED | TUBE SIZE | METRIC TUBE | LENGTH | WIDTH | HEIGHT |
|--------------|-----------|-------------|--------------|-------------|--------------|
| 40CBV-PB4-04 | 1/4" ID | 6.4mm ID | 1.43" (36mm) | .63" (16mm) | 1.28" (33mm) |
| 40CBV-PB4-06 | 3/8" ID | 9.5mm ID | 1.43" (36mm) | .63" (16mm) | 1.28" (33mm) |



ELBOW PTF PLUG

| NON-VALVED | TUBE SIZE | METRIC TUBE | LENGTH | WIDTH | HEIGHT |
|---------------|------------------|--------------------|--------------|-------------|--------------|
| 40CBV-PB10-04 | 1/4" OD, .17" ID | 6.4mm OD, 4.3mm ID | 1.43" (36mm) | .63" (16mm) | 1.28" (33mm) |
| 40CBV-PB10-06 | 3/8" OD, .25" ID | 9.5mm OD, 6.4mm ID | 1.43" (36mm) | .63" (16mm) | 1.28" (33mm) |