

Z-Series Pumps



FEATURES

- > Electronic air displacement pipetting modules
- > Exceptional precision and accuracy
- > Can be configured for mounting to a robotic arm
- > Interfaces with the M-Series motion controllers

CUSTOMER REQUIREMENTS

- > Drive Recommendations Pump should typically be driven with a 24 VDC bipolar chopper drive, ½ step, at rated current. Higher voltage may be required at higher step rates.

CONFIGURED OPTIONS

- > Available in 200 µL, 1000 µL, 2000 µL and 5000 µL

BASE MODEL

- 200 µL
- 1000 µL
- 2000 µL
- 5000 µL



(Shown with optional Tip Adapter and Tip)

SPECIFICATIONS				
	200 μ L Cat. # 0948	1000 μ L Cat. # 0949	2000 μ L Cat. # 0950	5000 μ L Cat. # 0951
Tip Adapter Cat	10005	10006	10007	10008
Disposable Tip Cat	10000 (96/rack)	10001 (100/rack)	10002 (60/rack)	10003 (24/rack)
Step Resolution Per Full Step Per Half Step	0.381 μ L 0.191 μ L	1.527 μ L 0.763 μ L	3.808 μ L 1.904 μ L	7.616 μ L 3.808 μ L
Weight Z-Pump without Tip Adapter Z-Pump with Tip Adapter Z-Pump with Tip Adapter and Tip	2.17 oz (61.6 gm) 2.49 oz (70.6 gm) 2.50 oz (70.9 gm)	2.65 oz (75.0 gm) 3.06 oz (86.7 gm) 3.09 oz (87.6 gm)	2.74 oz (77.8 gm) 3.12 oz (88.6 gm) 3.17 oz (90.0 gm)	3.13 oz (88.7 gm) 4.25 oz (120.5 gm) 4.33 oz (122.7 gm)
Syringe Data Bore Stroke	0.1721" (4.37 mm) 0.709" (18.00 mm)	0.3441" (8.74 mm) 0.709" (18.00 mm)	0.5441" (13.82 mm) 0.709" (18.00 mm)	0.7694" (19.54 mm) 0.709" (18.00 mm)
Fluid Contact Materials (in case of accidental fluid aspiration)	Acetal, PTFE, Silicone Lubricant, Buna N, Neoprene, Borosilicate Glass and Stainless Steel			

FUNCTIONAL PARAMETERS	
Performance (at full volume) with tip adapter and tip noted above Accuracy within Precision within	$\pm 3\%$ 1%
Motor / Leadscrew Data Travel / Full Step Travel / Half Step Resistance / Phase Inductance / Phase Rated Current Rated Voltage	0.001" (0.0254 mm) 0.0005" (0.0127 mm) 14.7 Ω 8.5 mH 0.34 A 5.0 V

200 µL, Cat. # 0948

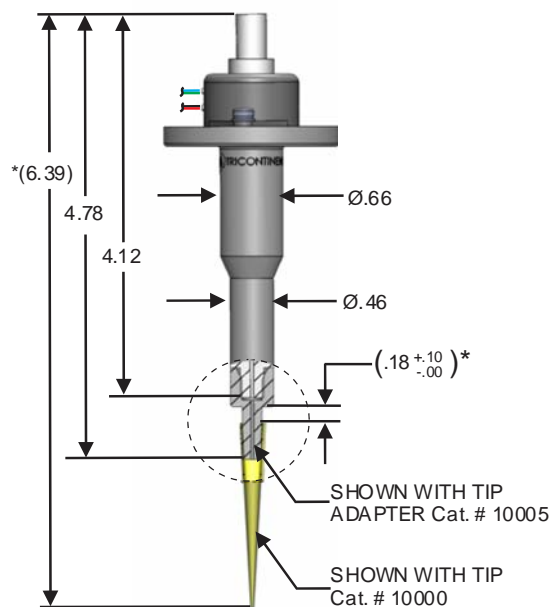

1000 µL, Cat. # 0949

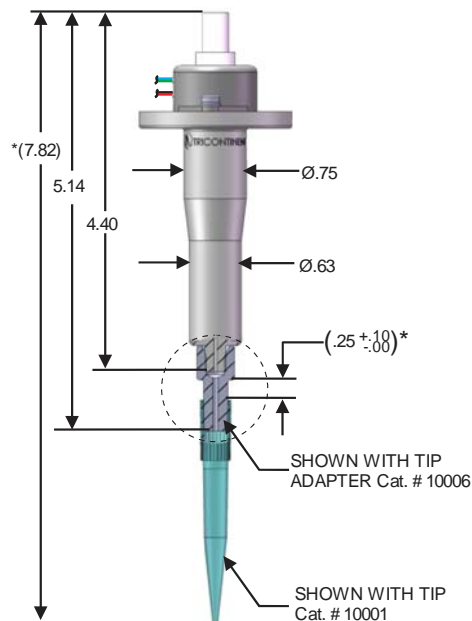

2000 µL, Cat. # 0950

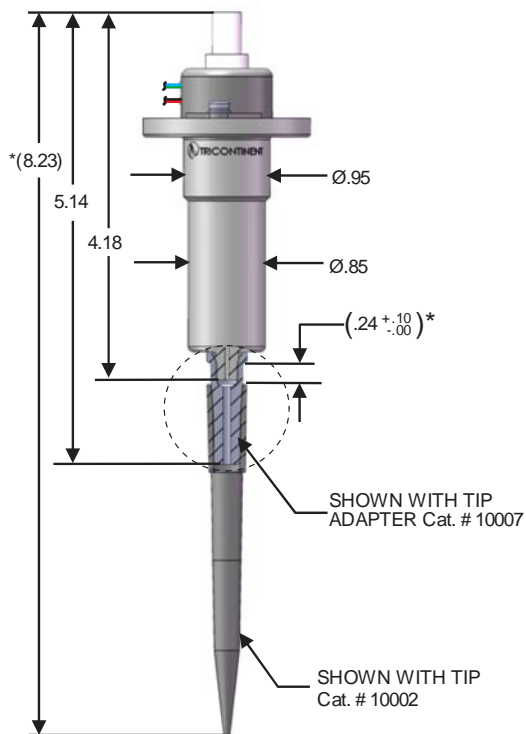

5000 µL, Cat. # 0951

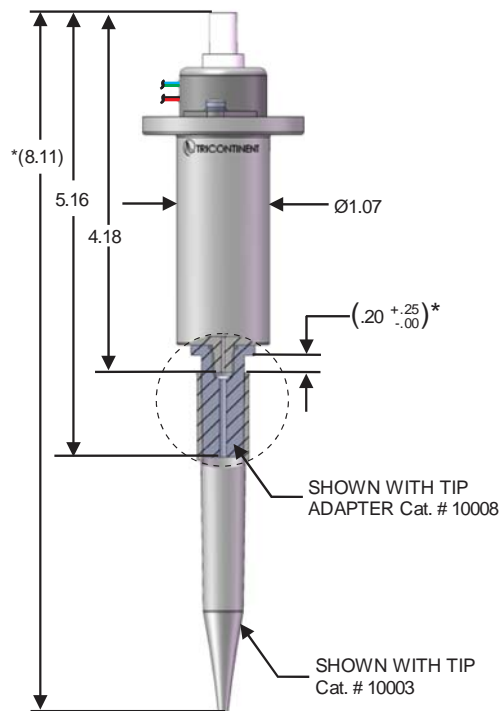

*Note: Each tip is designed to seal within the reference gap dimension shown. Customers should perform their own testing to determine optimum force/ location for sealing and tip stripping.

Z-SERIES PUMP INTERFACE DETAILS

Dimensions/Features noted are typical for any size, Z-Series Pump (5000 ml shown)

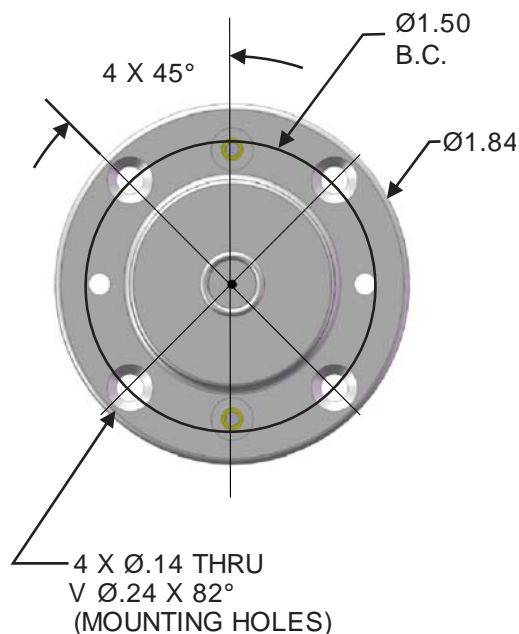
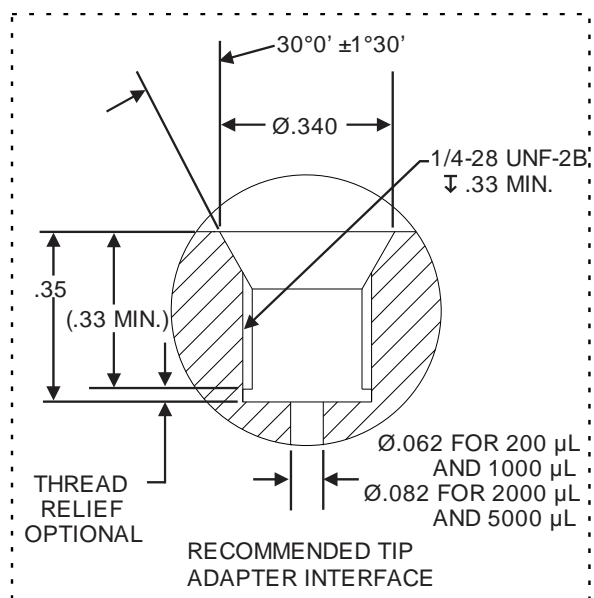
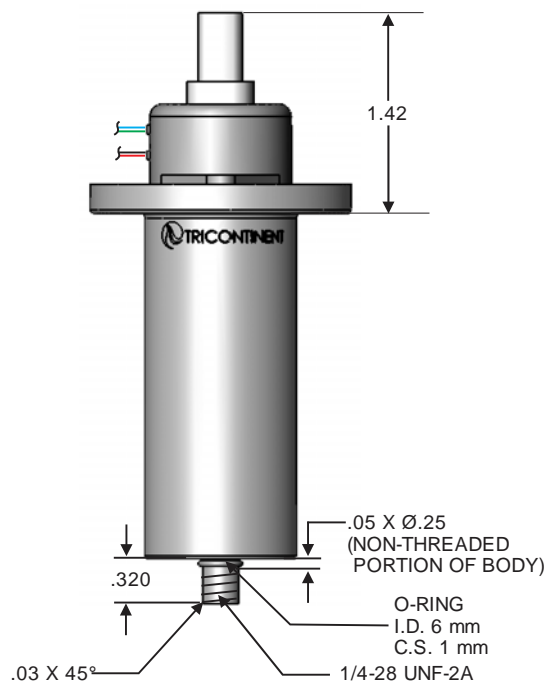
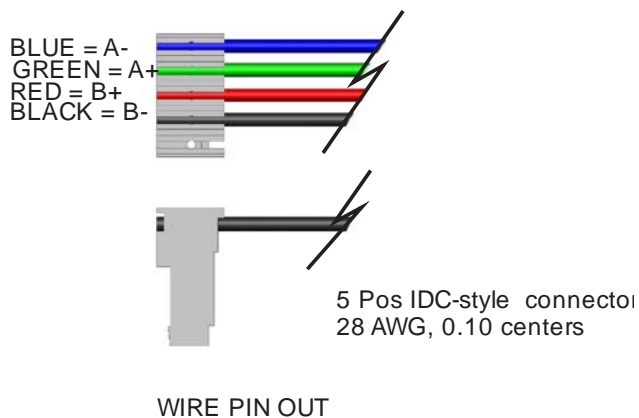

Note: Dimensions in inches unless otherwise specified.

AIR DISPLACEMENT PUMP SOLUTIONS FOR OEMS WORLDWIDE

tricontinent.com



TriContinent by Gardner Denver
12555 Loma Rica Drive
Grass Valley, CA 95945
Tel: 800-937-4738
Fax: 530-273-2586
liquidhandling@tricontinent.com

The information presented in this material is based on technical data and test results of nominal units. It is believed to be accurate and reliable and is offered as an aid to help in the selection of TriContinent products. It is the responsibility of the user to determine the suitability of the product for the intended use and the user assumes all risk and liability in connection there with. TriContinent does not warrant, guarantee or assume any obligation or liability in connection with this information.

Photos of products pictured in this catalog do not necessarily represent a specific model number. To obtain further information for custom options, contact your local TriContinent office.

Printed in USA Form No. MKT90024 K © Gardner Denver TriContinent. All rights reserved.

TRICONTINENT
by Gardner Denver